



# Freestanding Dishwasher

V60DWW15/ VGGDW60SS



## Instruction Manual

**12 MONTH WARRANTY**

# Contents

Guide to the Appliance	2
Caring for the Environment	3
Safety Information and Warnings	4
Installation Instructions	7
Getting Started	11
Basic Set Up	16
Operation Instructions	21
Troubleshooting	24
Care and Maintenance	27
Technical Specifications	31

# Guide to the Appliance

## Control Panel

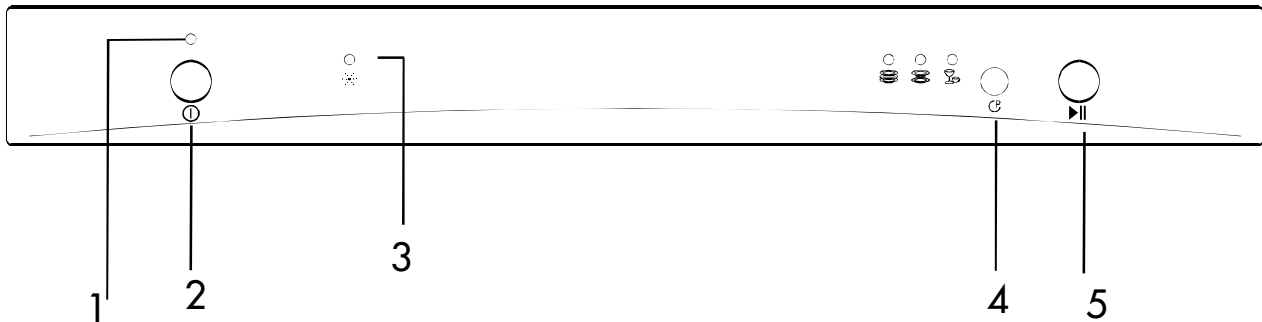

1. Power indicator light: To show the power supply.
2. Power switch: To turn on/off the power supply.
3. Rinse aid warning light: To show when the dispenser needs to be refilled.
4. Washing Program Selector: To select one of the three washing programs.
5. Start/Pause button: To start the selected washing program or pause the washing program when the machine is operating.

## Dishwasher Features

### Front View

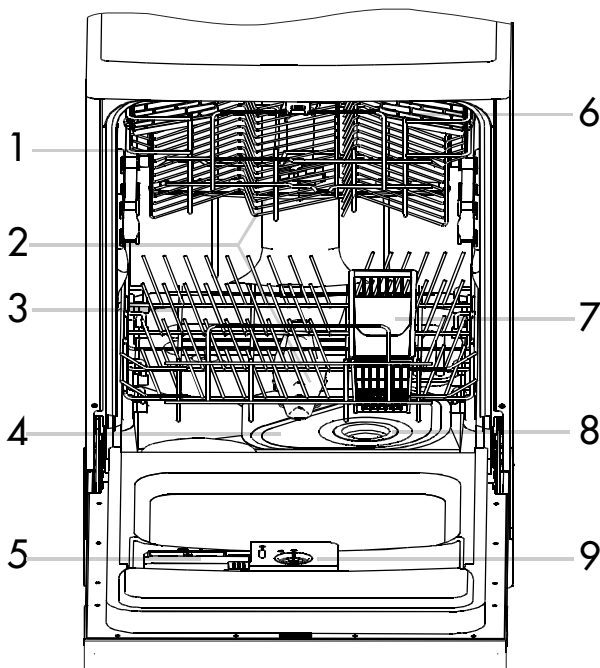

### Back View

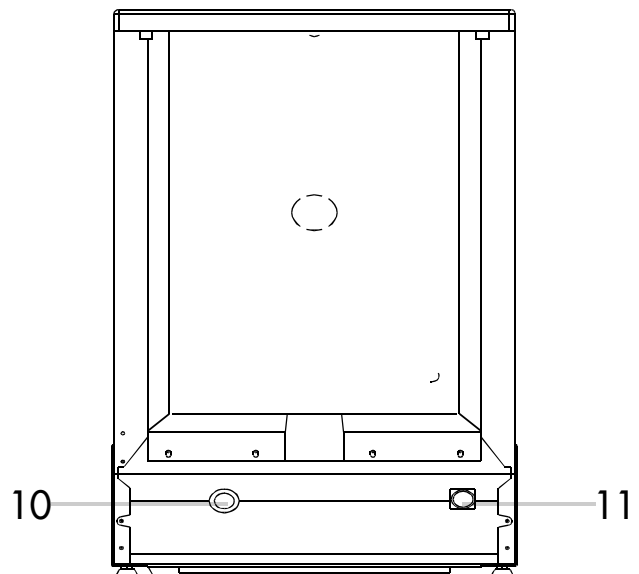

- |                 |                        |                          |
|-----------------|------------------------|--------------------------|
| 1. Upper basket | 5. Detergent dispenser | 9. Rinse aid dispenser   |
| 2. Spray arms   | 6. Cup shelf           | 10. Drain pipe connector |
| 3. Lower basket | 7. Cutlery basket      | 11. Inlet pipe connector |
| 4. Main filter  | 8. Coarse filter       |                          |

**Note:** Due to production improvements, the appliance may differ slightly from the diagram shown. Diagrams in this instruction manual are ready for reference only.

# Caring for the Environment

## Responsible disposal of the packaging

The packaging of your appliance has been selected from environmentally friendly materials and can usually be recycled. Please ensure these are disposed of correctly.

Plastic wrapping can be a suffocation hazard for babies and young children, please ensure all packaging materials are out of reach and are safely disposed of. Please ensure they are offered for recycling rather than throwing these materials away.

## Responsible disposal of the appliance

At the end of its working life, do not throw this appliance out with your household rubbish. An environmentally friendly method of disposal will ensure that valuable raw materials can be recovered and used again.

Electrical and electronic appliances contain materials and substances which, if handled or disposed of incorrectly, could be potentially hazardous on the environment and human health.

Observe any local regulations regarding the disposal of electrical consumer goods and dispose of it appropriately for recycling. Contact your local authorities for advice on recycling facilities in your area.

The plug must be rendered useless and the cable cut off directly behind the appliance or the machine to prevent misuse.

**DANGER.** Risk of child entrapment: When discarding a dishwasher, make sure to take off the door and the spring action or bolt catch. Leave the shelves in place so that children cannot easily climb in, get trapped inside and suffocate.

# Safety Information and Warnings

**IMPORTANT.** To get the best performance from your dishwasher, read all instructions before using the appliance for the first time.

Read this instruction manual thoroughly before first use, even if you are familiar with this type of product. We have provided many important safety statements in this manual concerning the use of this appliance. Always read and observe all safety statements. They reduce the risk of fire, electric shock and injury when correctly adhered to.

Keep the instruction manual in a safe place for future reference, along with the purchase receipt. If applicable, pass these instructions on to the next owner of the appliance.

This appliance is intended to be used in household and similar applications such as:

- Staff kitchen areas in shops, offices and other working environments.
- Farm houses
- Clients in hotels, motels and other residential type environments
- Bed and breakfast type environments.

Pay particular attention to safety messages that follow the words **WARNING** or **IMPORTANT**. These words are used to alert you to a potential hazard that can seriously injure you and others.

The instructions will tell you how to reduce the chance of injury and let you know what can happen if the instructions are not followed.

**WARNING** means that failure to read this safety statement may result in extensive product damage or serious personal injury.

**IMPORTANT** means that failure to read this safety statement may result in minor or moderate personal injury, property or equipment damage.

We assume no liability for any eventual damages caused by misuse of the appliance or non-compliance with the instructions in this manual.

# Safety Information and Warnings

**WARNING.** When using your dishwasher, follow the precautions listed below:

## Grounding Instructions

- This appliance must be grounded. In the event of a malfunction or breakdown, grounding will reduce the risk of an electric shock by providing a path of least resistance of electric current. This appliance is equipped with a cord having an equipment-grounding conductor and a grounding plug.
- The plug must be plugged into an appropriate outlet that is installed and grounded in accordance with all local codes and ordinances.
- **WARNING.** Improper connection of the equipment-grounding conductor can result in the risk of an electric shock.
- Check with a qualified electrician or service representative if you are in doubt whether the appliance is properly grounded. Do not modify the plug provided with the appliance; if it does not fit the outlet. Have a proper outlet installed by a qualified electrician.

## Proper Use

- Do not abuse, sit on, or stand on the door or dish rack of the dishwasher.
- Do not touch the heating element during or immediately after use. (This instruction is only applicable to machines with a visual heating element.)
- Do not operate your dishwasher unless all enclosure panels are properly in place. Open the door very carefully if the dishwasher is operating; there is a risk of water squirting out.
- Do not place any heavy objects on or stand on the door when it is open. The appliance could tip forward.
- When loading items to be washed:
  1. Locate sharp items so that they are not likely to damage the door seal;
  2. **Warning:** Knives and other utensils with sharp points must be loaded in the basket with their points down or placed in a horizontal position.
- When using your dishwasher, you should prevent plastic items from coming into contact with the heating element. (This instruction is only applicable to machines with a visual heating element.)
- Check that the detergent compartment is empty after completion of the wash cycle.
- Do not wash plastic items unless they are marked dishwasher safe or the equivalent. For plastic items not so marked, check the manufacturer's recommendations.
- Use only detergent and rinse additives designed for an automatic dishwasher.
- Never use soap, laundry detergent, or hand washing detergent in your dishwasher. Keep these products out of the reach of children.
- Keep children away from detergent and rinse aid, keep children away from the open door of the dishwasher, there could still be some detergent left inside.

# Safety Information and Warnings

- This appliance is not intended for use by persons (including children) with reduced physical, sensory or mental capabilities, or lack of experience and knowledge, unless they have been given supervision or instruction concerning use of the appliance by a person responsible for their safety.
- Children should be supervised to ensure that they do not play with the appliance.
- Dishwasher detergents are strongly alkaline, they can be extremely dangerous if swallowed. Avoid contact with skin and eyes and keep children away from the dishwasher when the door is open.
- The door should not be left open, since this could increase the risk of tripping.
- If the supply cord is damaged, it must be replaced by the manufacturer or its service agent or a similarly qualified person in order to avoid a hazard.
- Remove the door to the washing compartment when removing an old dishwasher from service or discarding it.
- Please dispose of packing materials properly.
- Use the dishwasher only for its intended function.
- During installation, the power supply cord must not be excessively or dangerously bent or flattened. Do not tamper with controls.
- The appliance is to be connected to the water mains using new hose sets and old hose-sets should not be reused.
- When not using the appliance for a long period, disconnect the mains plug from the mains socket and turn off the water tap.
- Inlet water supply,  
Cold water pressure: 600kPa max - 50 kPa min.  
If cold water pressure is excess of 600 kPa, a pressure reducing valve should be used. Check for leaks.
- The maximum number of place settings to be washed is 12.
- Where flooding due to a burst hose occurs due to excessive water pressure and a pressure limiting valve not being fitted we will not be liable for any damage resulting from flooding and this device not being fitted.

# Installation Instructions

## Positioning the Appliance

Position the appliance in the desired location. The back should rest against the wall behind it, and the sides, along the adjacent cabinets or walls, see below for measurements and required space. The dishwasher is equipped with water supply and drain hoses that can be positioned either to the right or the left sides to facilitate proper installation.

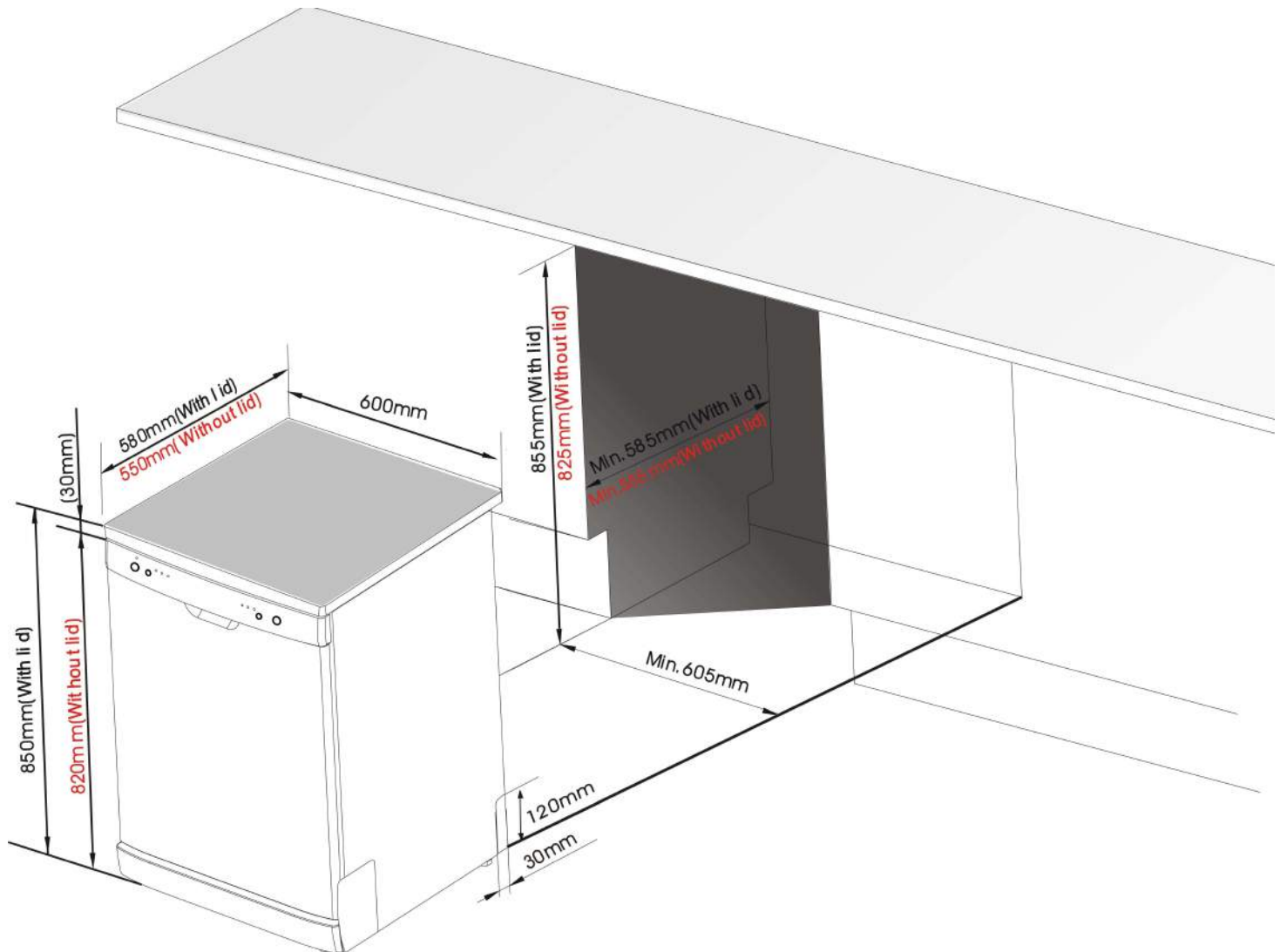

## Levelling the Appliance

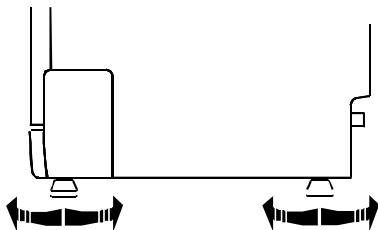

Once the appliance is positioned for levelling, the height of the dishwasher may be altered via adjustment of the screwing level of the feet. In any case, the appliance should not be inclined more than 2 degrees.



# Installation Instructions

## Power Connection

**WARNING.** For personal safety:

- Do not use an extension cord or an adapter plug with this appliance.
- Do not, under any circumstances cut or remove the earthing connection from the power cord.

## Electrical Requirements

Please look at the rating label to know the rating voltage and connect the dishwasher to the appropriate power supply. Ensure the power circuit has a minimum of a 10amp fuse or circuit breaker.

## Electrical Connection

**WARNING.** Insure proper ground exists before use.

Ensure the voltage and frequency of the power being used corresponds to those on the rating plate. Only insert the plug into an electrical socket which is earthed properly. If the electrical socket to which the appliance must be connected is not appropriate for the plug, replace the socket, rather than using an adaptor or the like as they could cause overheating and burns.

## Grounding Instructions

This appliance must be earthed. In the event of a malfunction or breakdown, earthing will reduce the risk of electric shock by providing a path of least resistance for the electric current. This appliance is equipped with a cord having an equipment-earthing conductor and an earthing plug. The plug must be plugged into an appropriate outlet that is installed and earthed in accordance with all local standards and requirements.

**WARNING.**

- Improper connection of the equipment earthing conductor can result in the risk of an electric shock.
- Check with a qualified electrician or service representative if you are in doubt whether the appliance is properly earthed.
- Do not modify the plug provided with the appliance. If the plug does not fit properly to the outlet, please have a qualified electrician to install a proper outlet.

# Installation Instructions

## Water Connection

### Cold Water Connection

Connect the cold water supply hose to a threaded 3/4(inch) connector and make sure that it is fastened tightly in place.

If the water pipes are new or have not been used for an extended period of time, let the water run to make sure that the water is clear. This precaution is necessary to avoid the risk of the water inlet being blocked and damaging the appliance.

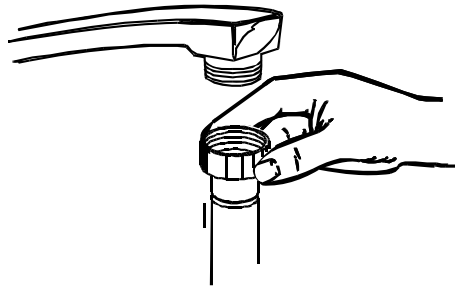

### Drain Hose Connection

Upon connection of the dishwasher please ensure the following points have been followed before leaving the premises:

- Sink 'S' Bend spigot hole that the drain hose connects to be drilled out using a 13mm drill to allow for sufficient draining.
- Prior to fully installing the dishwasher, run it through a short cycle and inspect all water connections including those behind the appliance for leaks.

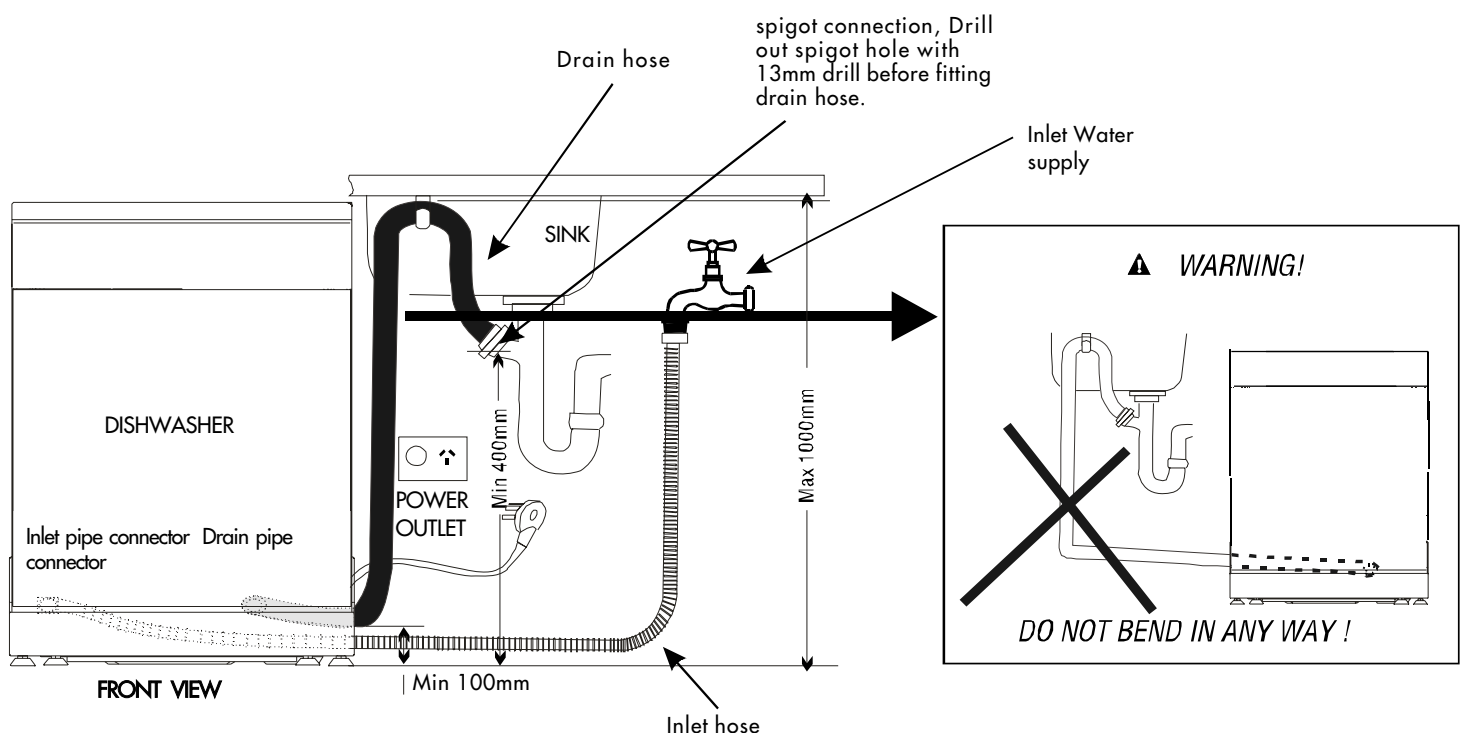

# Installation Instructions

## How to Drain Excess Water from Hoses

If the sink is 1000mm high from the floor, the excess water in hoses cannot be drained directly into the sink. It will be necessary to drain excess water from hoses into a bowl or suitable container that is held outside and lower than the sink.

## Water Outlet (Drain Hose)

Connect the water drain hose. The drain hose must be correctly fitted to avoid water leaks. Ensure that the water inlet hose is not kinked or squashed.

Drill out drain pipe spigot to 13mm diameter prior to fitting drain hose.

## Extension Hose

If you need a drain hose extension, make sure to use a similar drain hose. It must be no longer than 4 metres; otherwise the cleaning effect of the dishwasher could be reduced.

## Syphon Connection

The waste connection must be at a height of between 40cm (minimum) and 100cm (maximum) from the bottom of the dish. The water drain hose should be fixed by a hose clip.

## Before First Use

The following things should be checked before starting the dishwasher.

- The dishwasher is level and fixed properly.
- The inlet valve is open.
- There is no leakage at the connections of the hoses.
- The power cord is not trapped or squashed.
- The appliance is plugged in and the power is switched on.
- The inlet and drain hoses are not kinked or squashed.
- All packing materials and printings should be taken out from the dishwasher.

**IMPORTANT.** After installation, please make sure to keep this instruction manual. The content of this manual is very helpful to the users.

# Getting Started

Before using the appliance for the first time:

- Fill the rinse aid dispenser.
- Fill the detergent dispenser.

## Fill the Rinse Aid Dispenser

The rinse aid is released during the final rinse to prevent water from forming droplets on your dishes, which can leave spots and streaks. It also improves drying by allowing water to roll off the dishes. Your dishwasher is designed to use liquid rinse aids. The rinse aid dispenser is located inside the door next to the detergent dispenser. To fill the dispenser, open the cap and pour the rinse aid into the dispenser until the level indicator turns completely black. The volume of the rinse aid container is about 110ml.

## Function of Rinse Aid

Rinse aid is automatically added during the last rinse, ensuring thorough rinsing, and spot and streak free drying.

**IMPORTANT.** Only use branded rinse aid in the dishwasher. Never fill the rinse aid dispenser with any other substances (e.g. Dishwasher cleaning agent, liquid detergent). This would damage the appliance.

## When to Refill the Rinse Aid Dispenser

If there is no rinse-aid warning light in the control panel, you can estimate the amount from the colour of the optical level indicator "C" located next to the cap. When the rinse-aid container is full, the whole indicator will be dark. As the rinse-aid diminishes, the size of the dark dot decreases. You should never let the rinse aid level fall below  $\frac{1}{4}$  full.

As the rinse aid diminishes, the size of the black dot on the rinse aid level indicator changes, as illustrated below.

- Full
- 3 / 4 full
- 1 / 2 full
- ◐ 1 / 4 full - Should refill to eliminate spotting
- Empty

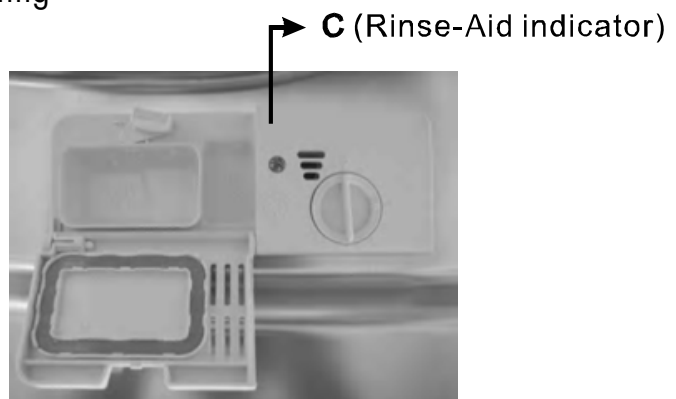

# Getting Started



1. To open the dispenser, turn the cap to the 'open' (left) arrow and lift it out.
2. Pour the rinse aid into the dispenser, being careful not to overfill.
3. Replace the cap by inserting it aligned with 'open' arrow turning it to the 'closed' (right) arrow.

**IMPORTANT.** Clean up any rinse aid spilt while filling with an absorbent cloth to avoid excessive foaming during the next wash. Don't forget to replace the cap before you close dishwasher door.

## Adjusting Rinse Aid Dispenser

The rinse aid dispenser has four or six settings. Always start with the dispenser set on "4". If spots and poor drying are a problem, increase the amount of rinse aid dispensed by removing the dispenser lid and rotating the dial to "5". If the dishes still are not drying properly or showing spots, adjust the dial to the next higher lever until your dishes are spot-free. The recommended setting is "4". (Factory value is "4".)

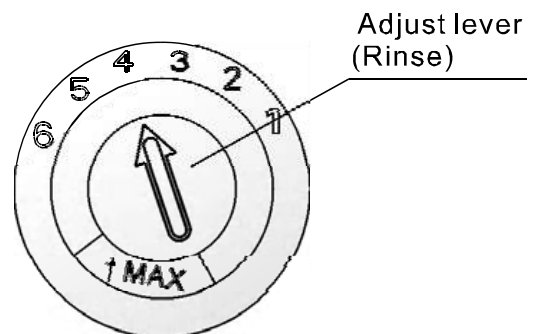

**IMPORTANT.** Increase the dose if there are drops of water or lime spots on the dishes after washing. Reduce it if there are sticky whitish stains on your dishes or a bluish film on glassware or knife blades.

## Function of Detergent

Detergents with their chemical ingredients are necessary to remove dirt, crush dirt and transport it out of the dishwasher. Most of the commercial quality detergents are suitable for this purpose.

# Getting Started

## Detergents

There are 3 types of detergents,

1. With phosphate and with chlorine.
2. With phosphate and without chlorine.
3. Without phosphate and without chlorine.

Normally new pulverised detergent is without phosphate. Thus the water softener function of phosphate is not given. In this case we recommend to fill salt in the salt container even when the hardness of water is only 6 °dH. If detergents without phosphate are used in the case of hard water often white spots appear on dishes and glasses. In this case please add more detergent to reach better results. Detergents without chlorine only bleach a little. Strong and coloured spots will not be removed completely. In this case please choose a program with a higher temperature.

## Concentrated Detergent

Based on their chemical composition, detergents can be split in two basic types:

- Conventional, alkaline detergents with caustic components.
- Low alkaline concentrated detergents with natural enzymes.

The use of “normal” washing programs in combination with concentrated detergent reduces pollution and is good for your dishes; these wash programs are specifically matched to the dirt-dissolving properties of the enzymes of the concentrated detergent. For this reason “normal” wash programs in which concentrated detergents are used can achieve the same results that can otherwise only be achieved using “intensive” programs.

## Detergent Tablets

Detergent tablets of different brands dissolve at different speeds. For this reason some detergent tablets cannot dissolve and develop their full cleaning power during short programs. Therefore please use long programs when using detergent tablets, to ensure the complete removal of detergent residuals.

## Detergent Dispenser

The dispenser must be refilled before the start of each wash cycle following the instructions provided in the wash cycle table. Your dishwasher uses less detergent and rinse aid than conventional dishwashers. Generally, only one tablespoon of detergent is needed for a normal wash load. More heavily soiled items need more detergent. Always add the detergent just before starting the dishwasher, otherwise it could get damp and will not dissolve properly.

# Getting Started

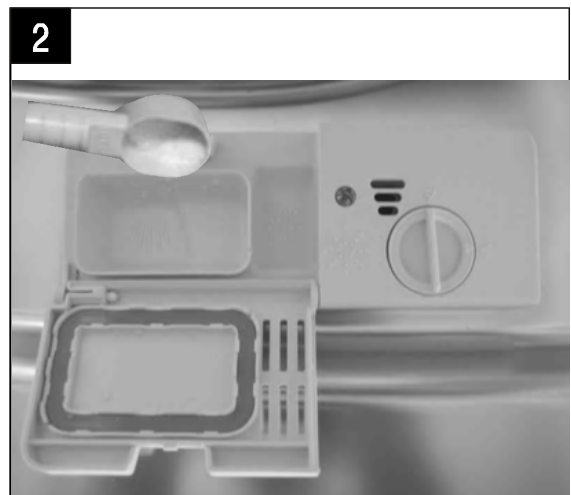
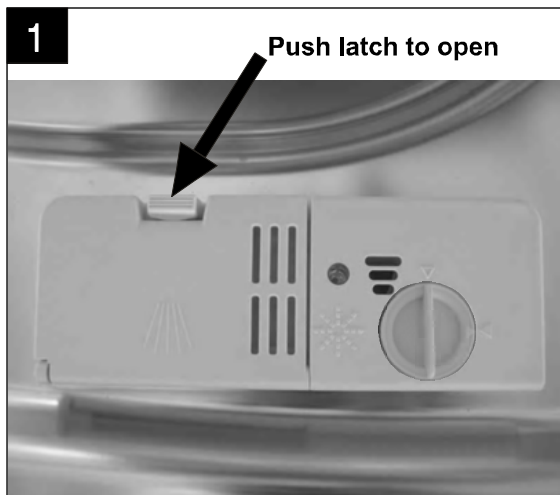

## IMPORTANT.

- If the lid is closed: press release button. The lid will spring open.
- Always add the detergent just before starting each wash cycle.
- Only use branded detergent and rinse aid in the dishwasher.

**WARNING.** Dishwasher detergent is corrosive! Take care to keep it out of reach of children.

## Proper Use of Detergent

Use only detergent specifically made for the use in dishwashers. Keep your detergent fresh and dry. Don't put powdered detergent into the dispenser until you're ready to wash dishes.

## Filling the Detergent Dispenser

Fill the detergent dispenser with detergent. The marking indicates the dosing levels, as illustrated below:

1. Place of main wash cycle detergent in area A.  
"MIN" means approximately 20g of detergent.
2. Place of pre-wash cycle detergent in area B.  
Approximately 5g of detergent.
3. Close the lid and press until it locks in place.

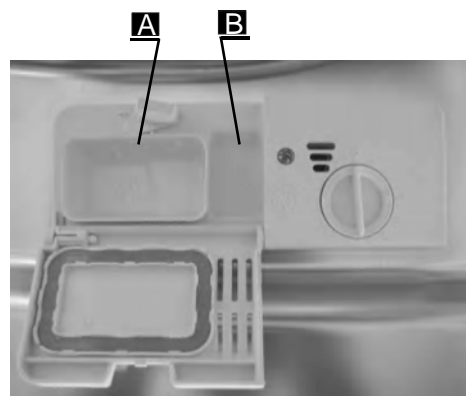

If the dishes are heavily soiled, place an additional detergent dose in the pre-wash detergent chamber. This detergent will take effect during the pre-wash phase.

Please observe the manufacturers dosing and storage recommendations as stated on the detergent packaging.

# Getting Started

## **IMPORTANT.**

- The information about the amount of detergent for the single programme please refer to the Wash Cycle Table on the page 20.
- Please be aware, that according to the level of soiling and the specific hardness of water differences are possible.
- Please observe the manufacturer's recommendations on the detergent packaging.



# Basic Set Up

## IMPORTANT.

- Consider buying utensils which are identified as dishwasher-proof.
- Use a mild detergent that is described as 'kind to dishes'. If necessary, seek further information from the detergent manufacturers.
- For particular items, select a program with as low a temperature as possible.
- To prevent damage, take glass and cutlery out of the dishwasher as soon as possible after the program has ended.

### Not Suitable for the Dishwasher

- Cutlery with wooden, horn china or mother-of-pearl handles.
- Plastic items that are not heat resistant.
- Older cutlery with glued parts that are not temperature resistant.
- Bonded cutlery items or dishes.
- Pewter or cooper items.
- Crystal glass.
- Steel items subject to rusting.
- Wooden platters.
- Items made from synthetic fibres.

### Limited Suitability for the Dishwasher

- Some types of glasses can become dull after a large number of washes.
- Silver and aluminium parts have a tendency to discolour during washing
- Glazed patterns may fade if machine washed frequently.

## Before and After Loading the Dishwasher Baskets

For best performance of the dishwasher, follow these loading guidelines. Features and appearance of baskets and cutlery baskets may vary from your model.

Scrape off any large amounts of leftover food. Soften remnants of burnt food in pans. It is not necessary to rinse the dishes under running water.

Place objects in the dishwasher in following way:

1. Items such as cups, glasses, pots/pans, etc. should be faced downwards.
2. Curved items or ones with recesses, should be loaded aslant so that water can run off.
3. All utensils are stacked securely and cannot tip over.
4. All utensils are placed in the way that the spray arms can rotate freely during washing.

**IMPORTANT.** Very small items should not be washed in the dishwasher as they could easily fall out of the basket.

- Load hollow items such as cups, glasses, pans etc. With the opening facing downwards so that water cannot collect in the container or in a deep base.
- Dishes and items of cutlery must not lie inside one another, or cover each other.

# Basic Set Up

- To avoid damage to glasses, they must not touch.
- Load large items which are most difficult to clean into the lower basket.
- The upper basket is designed to hold more delicate and lighter dishware such as glasses, coffee and tea cups
- Long bladed knives stored in an upright position are a potential hazard!
- Long and/or sharp items of cutlery such as carving knives must be positioned horizontally in the upper basket.
- Please do not overload your dishwasher. This is important for good results and for reasonable consumption of energy.

## Removing Dishes

To prevent water dripping from the upper basket into the lower basket, we recommend that you empty the lower basket first and then the upper basket.

## Loading the Upper Basket

The upper basket is designed to hold more delicate and lighter dishware such as glasses, coffee and tea cups and saucers, as well as plates, small bowls and shallow pans (as long as they are not too dirty).

Position the dishes and cookware so that they will not be moved by the spray of water.

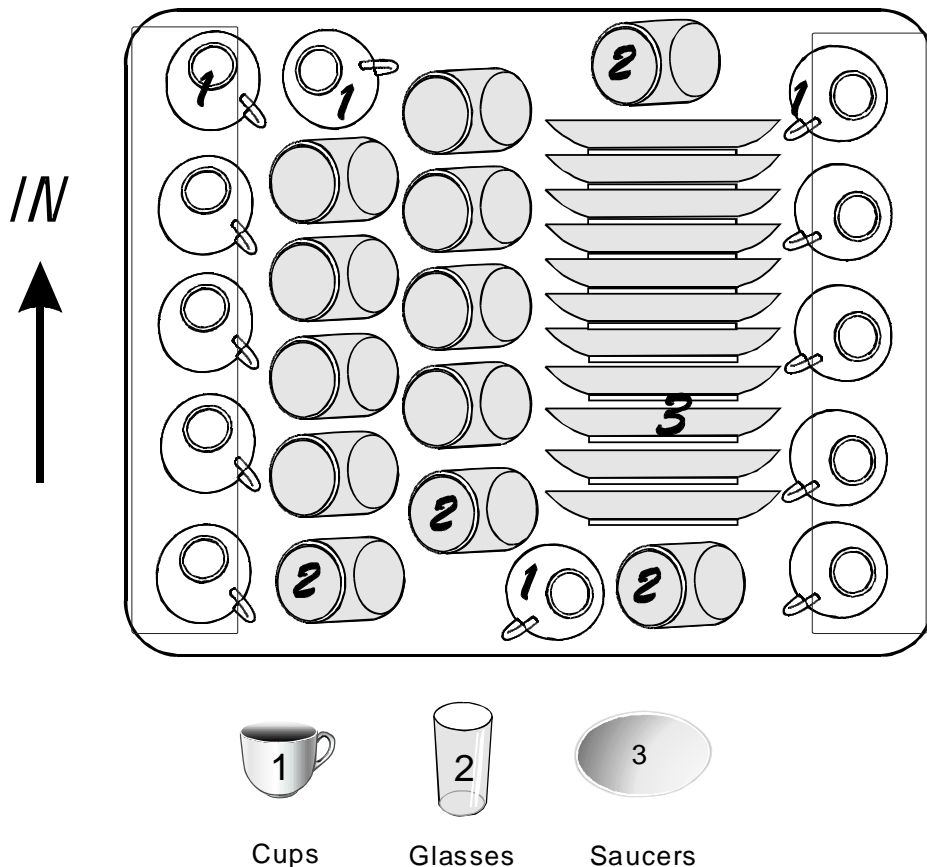

# Basic Set Up

## Loading the Lower Basket

We suggest that you place large items and items that are the most difficult to clean into the lower basket such as: pots, pans, lids, serving dishes and bowls, as shown in the figure below. It is preferable to place serving dishes and lids on the side of the racks in order to avoid blocking the rotation of the top spray arm.

### IMPORTANT.

- Pots, serving bowls, etc. must always be placed top down.
- Deep pots should be slanted to allow water to flow out.
- The bottom basket features folding spikes so that larger or more pots and pans can be loaded.

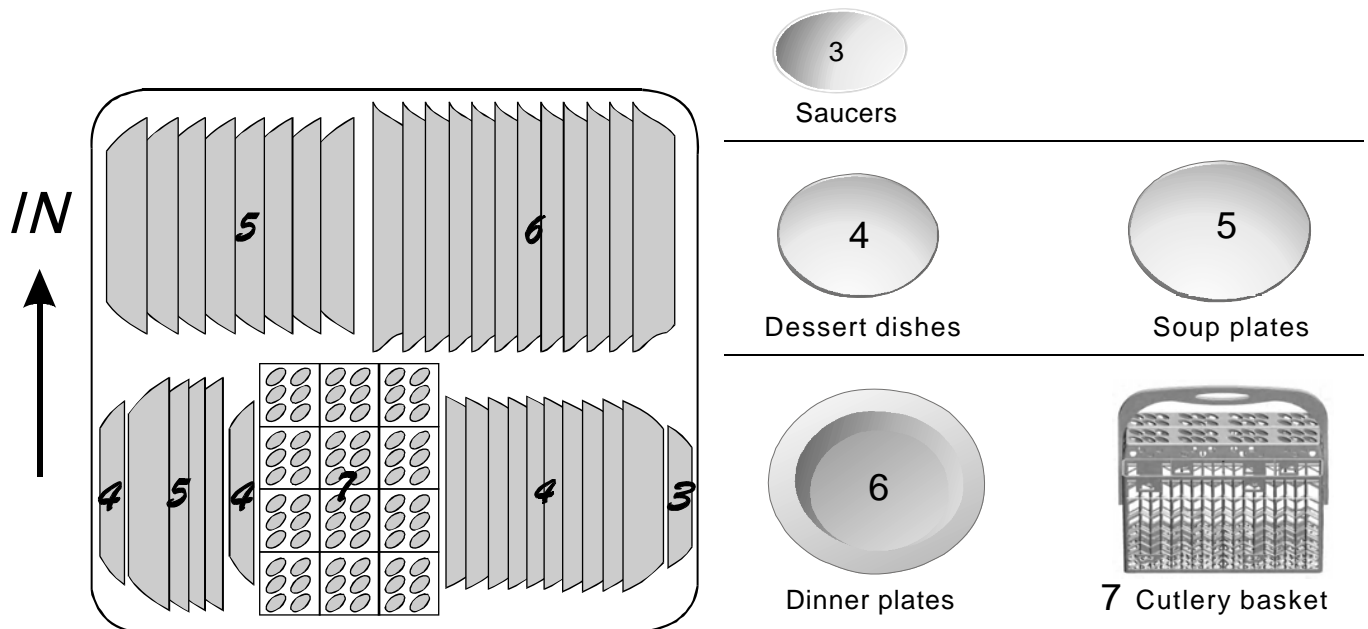

## Folding Spikes of Lower Basket

For better stacking of pots and pans, the spikes can be folded down as shown in the picture below.

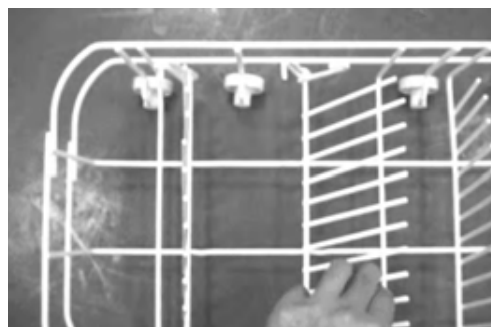

# Basic Set Up

## Adjusting the Upper Basket

The height of the upper basket can be adjusted in order to create more space for large utensils both for the upper/lower basket. The height of the upper basket can be adjusted by placing the wheels on a different height of the rails. Long items, serving cutlery, salad servers and knives should be placed on the shelf so that they do not obstruct the rotation of the spray arms. The shelf can be folded back or be removed when not required for use.

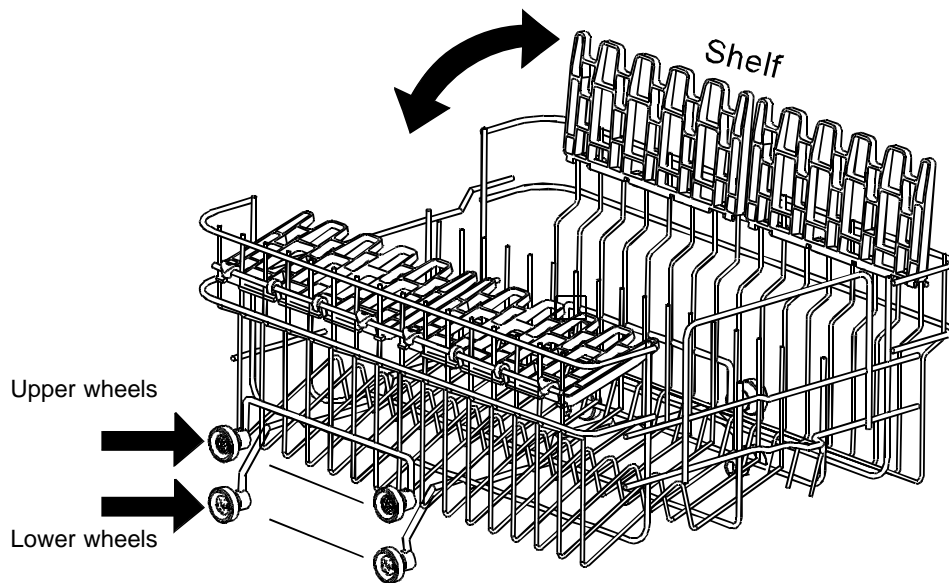

## Basic Set Up

## Cutlery Basket

Cutlery should be placed in the cutlery basket with the handles at the bottom. If the rack has side baskets, the spoons should be loaded separately into the appropriate slots, especially long utensils should be placed in the horizontal position at the front of the upper basket as shown in the picture below.

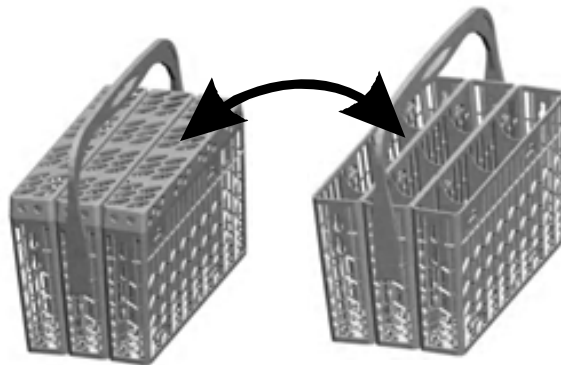
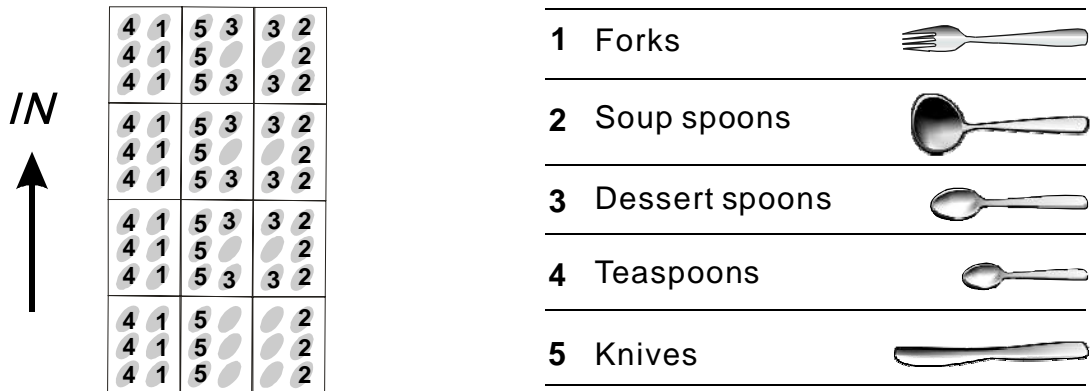

## WARNING.

- Do not not let any item extend through the bottom.
- Always load sharp utensils with the sharp point faced down.

**IMPORTANT.** For personal safety and top quality cleaning, place the silverware in the basket making sure that;

- They do not nest together.
- Silverware is placed with the handles down.
- But place knives and other potentially dangerous utensils with the handles up.

# Operation Instructions

**Wash Cycle Table**

Program	Cycle Selection Information	Cycle Description	Detergent pre/main	Running time (minutes)	Energy (Kwh)	Water (L)	Rinse Aid
Heavy	For heavily soiled loads, such as pots, plates, glasses and lightly soiled pans.	Pre-wash (50°C) Wash (50°C) Rinse Rinse(65°C) Drying	5/25g	160	1.2	15	Yes
Normal (AS/NZS 2007.1)	Standard daily cycle for normally soiled loads, such as pots, plates, glasses.	Wash Rinse Rinse Rinse Drying	5/25g	110	0.9	12	Yes
Rapid	A shorter wash for lightly soiled loads and quick wash	Wash (45°C) Rinse Rinse (45°C)	15g	30	0.4	12	

**IMPORTANT.** AS/NZS 2007.1: This program is the test cycle. The information for comparability test in accordance with AS/NZS 2007.1, as follows:

- Capacity: 12 setting
- Position Upper basket: upper wheels on rails
- Rinse aid setting: 6

We recommend you open the door slightly (50mm) to assist in drying of the dishes after every wash.

## Turning on the Dishwasher

### Starting a Wash Program

1. Draw out the lower and upper basket, load the dishes and push them back in.  
It is recommended to load the lower basket first, then the upper one (see the "Basic Set Up" section)
2. Pour in the detergent (see the "Getting Started" section)
3. Insert the plug into the socket. The power supply is 220-240 VAC /50 HZ, the specification of the socket is 10A 250VAC.
4. Make sure that the water supply tap is fully turned on.
5. Close the door, press the ON/OFF button and the ON/OFF light will turn on.

# Operation Instructions

6. Press the program button, the wash program will be changed as follows:  
**Heavy->normal->Rapid;**  
If a program is selected, the response light will light. Then press the Start/Pause button, the dishwasher will begin to start.

## Premise

1. A cycle that is underway can only be modified if it has only been running for a short time. Otherwise, the detergent may have already been released, and the appliance may have already drained the wash water. If this is the case and the program is changed, the detergent dispenser must be refilled (see the "Getting Started" section).
2. When you press the Start/Pause button to pause then press the button of program more than 3 seconds, you can cancel the running program and select another program (see the section entitled "Starting a Wash Program")

## Changing the Program

## Premise

1. You can modify the washing program, when the dishwasher has only run for a short time. Otherwise, the detergent may have already been released, and the appliance may have already drained the wash water. If this is the case, the detergent dispenser must be refilled (see the "Getting Started" section).
2. Press the button of Start/Pause to pause, then press the button of program more than 3 seconds, the machine will be in standby state, then you can change the program to the desired cycle setting (see the section entitled "Starting a Wash Program " ).

**IMPORTANT.** If you open the door while the appliance is washing, the machine will pause. When you close the door the machine will start working after 10 seconds.

The program lights show the state of the dishwasher;

- One of the program lights on, you can choose program-----stand by.
- One of the program lights on-----pause.
- One of the program lights blinking-----in operation.

**IMPORTANT.** If all the lights begin to glimmer, this indicates the machine is out of order, please turn off the main power and water supply before calling Viali customer care.

## Forgot to Add a Dish?

A forgotten dish can be added any time before the detergent cup opens.

1. Press the Start/Pause button.
2. Open the door a little to stop the washing.
3. After the spray arms stop working, you can open the door completely.
4. Add forgotten dishes.
5. Close the door.
6. Press the Start/Pause button, the dishwasher will continue to run after 10 seconds.

# Operation Instructions

## At the end of the Wash Cycle

When the working cycle has finished, the buzzer of the dishwasher will sound for 8 seconds, then stop. Turn off the appliance using the ON/OFF button and open the door of the dishwasher. Wait for a few minutes before unloading the dishwasher to avoid handling the dishes and utensils while they are still hot and more susceptible to breakage. They will also dry better.

## Switch Off the Dishwasher

The buzzer of the dishwasher sounds for 8 seconds, only in this case the program has ended.

1. Switch off the dishwasher by pressing the ON/OFF button.
2. Turn off the water tap if the appliance will not be used for a long period.

## Open the Door Carefully

Hot dishes are sensitive to knocks. The dishes should therefore be allowed to cool down for at least 15 minutes before being removing from the dishwasher.

Open the dishwasher door, leave it ajar the dishes will cool and the drying will be improved.

## Unloading the Dishwasher

It is normal that the dishwasher is wet inside.

Empty the lower basket first and then the upper one. This will avoid water dripping from the upper basket onto the dishes in the lower one.

**WARNING.** It is dangerous to open the door while the dishwasher is washing, the hot water may scald you.



# Troubleshooting

If you experience a problem with your appliance, check in the following tables for a solution to help you solve the problem. If after these checks the issue has not been solved, contact Viali customer care for advice.

## Technical Problems

Problem	Possible Cause	Solution
Appliance does not start.	Fuse blown or the circuit breaker triggered.	Replace fuse or reset circuit breaker. Remove any other appliances sharing the same circuit with the dishwasher
	Power supply is not turned on.	Make sure the dishwasher is turned on and the door is closed securely. Make sure the power cord is properly plugged into the wall socket.
	Error code: E1; Water pressure is low.	Check that the water supply is connected properly and the water is turned on.
	Door of dishwasher not properly closed.	Make sure to close the door properly and latch it.
Water not pumped from dishwasher	Kink in drain hose.	Check the drain hose.
	Filter clogged.	Check the coarse filter (see section titled "Cleaning the Filter")
	Kitchen sink clogged	Check the kitchen sink to make sure it is draining well. If the problem is the kitchen sink not draining, you may need a plumber rather than a technician for dishwashers.

## General Problems

Problem	Possible Cause	Solution
Suds inside the dishwasher.	Improper detergent.	Use only the dishwasher detergent to avoid suds. If this occurs, open the dishwasher and let suds evaporate. Add 3.5 litres of cold water to the tub. Close and latch the dishwasher, then Start the "soak" wash cycle to drain out the water. Repeat if necessary.
	Spilled rinse-aid.	Always wipe up rinse-aid spills immediately.
Stained tub interior.	Detergent with colourant was used.	Make sure that the detergent is the one without colourant.
White film on the inside surface.	Hard water minerals.	To clean the interior, use a damp sponge with dishwasher detergent and wear rubber gloves. Never use any other cleaner than dishwasher detergent for the risk of foaming or suds.
Rust stains on cutlery.	The affected items are not corrosion resistant.	The items should be corrosion resistant.

# Troubleshooting

## Noise

Problem	Possible Cause	Solution
Knocking noise in the wash cabinet.	A spray arm is knocking against an item in a basket.	Interrupt the program, and rearrange the items which are obstructing the spray arm.
Rattling noise in the wash cabinet.	Items of crockery are loose in the wash cabinet.	Interrupt the program, and rearrange the items of crockery.
Knocking noise in the water pipes.	This may be caused by on-site installation or the cross-section of the piping.	This has no influence on the dishwasher function. If in doubt, contact a suitably qualified plumber.

## Unsatisfactory Washing Result

Problem	Possible Cause	Solution
The dishes are not clean.	The dishes were not loaded correctly.	See notes in the "Basic Set Up" section.
	The program was not powerful enough.	Select a more intensive programme. See "Wash Cycle Table".
	Not enough detergent was dispensed.	Use more detergent, or change your detergent.
	Items are blocking the path of spray arms	Rearrange the items so that the spray can rotate freely.
	The filter combination in the base of wash cabinet is not clean or is not correctly fitted. This may cause the spray arm jets to get blocked.	Clean and/or fit the filter combination correctly. Clean the spray arm jets. See "Cleaning the Spray Arms" section.
Cloudiness on glassware.	Combination of soft water and too much detergent.	Use less detergent if you have soft water and select a shortest cycle to wash the glassware and to get them clean.
Black or grey marks on dishes.	Aluminium utensils have rubbed against dishes.	Use a mild abrasive cleaner to eliminate marks.
Detergent left in dispenser cups.	Dishes block detergent cups.	Re-load the dishes properly.

# Troubleshooting

## Unsatisfactory Drying Result

Problem	Possible Cause	Solution
Dishes are not drying.	Improper loading.	Load the dishwasher as suggested in the directions.
	Too little rinse-aid.	Increase the amount of rinse-aid/refill the rinse-aid dispenser.
	Dishes are removed too soon.	Do not empty your dishwasher immediately after washing. Open the door slightly so that the steam can escape. Begin unloading the dishwasher only once the dishes are barely warm to the touch. Empty the lower basket first. This prevents water from dropping off dishes in the upper basket.
	Wrong program has been selected.	In short programs the washing temperature is lower. This also lowers cleaning performance. Choose a program with a long washing time.
	Use of cutlery with a low-quality coating.	Water drainage is more difficult with these items. Cutlery or dishes of this type are not suitable for washing in the dishwasher.

## Error Code

When some malfunctions occur, the appliance will display error codes to warn you:

Code	Meaning	Possible Cause
The Rapid light flashes quickly.	Longer inlet time.	Tap is not opened or water intake is restricted or water pressure is too low.
The Heavy light flashes quickly.	Over flow.	Some element of the dishwasher leaks.

## WARNING.

- If an overflow occurs, turn off the main water supply before calling Viali customer care or a qualified technician.
- If there is water in the base pan because of an overfill or small leak, the water should be removed before restarting the dishwasher.

# Care and Maintenance

## Filtering System

The filter prevents larger remnants of food or other objects from getting inside the pump. The residues may block the filter; in this case they must be removed.

The filter system consists of a coarse filter, a flat (Main filter) And a micro filter (Fine filter).

### Main Filter

1. Food and soil particles trapped in this filter are pulverized by a special jet on the lower spray arm and washed down to drain.

### Coarse Filter

2. Larger items, such as pieces of bones or glass that could block the drain are trapped in the coarse filter. To remove the items caught by the filter, gently squeeze the tap on the top of this filter and lift out.

### Fine Filter

3. This filter holds soil and food residues in the sump area and prevents it from being redeposited on the dishes during wash cycle.

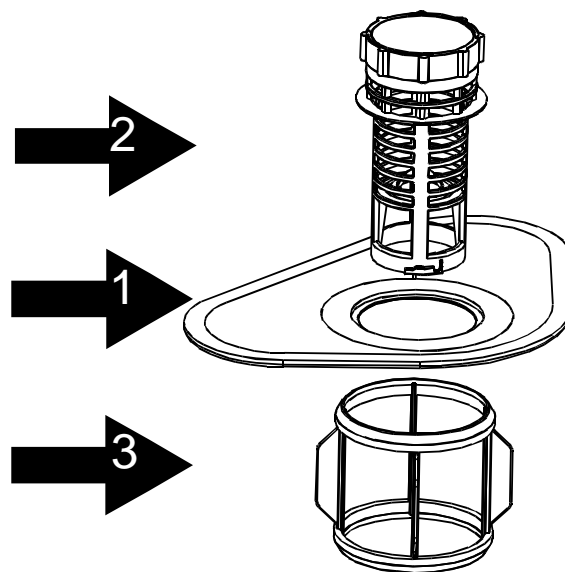

# Care and Maintenance

## Filter Assembly

The filter efficiently removes food particles from the wash water, allowing it to be recycled during the cycle. For best performance and results, the filter must be cleaned regularly. For this reason, it is a good idea to remove the larger food particles trapped in the filter after each wash cycle by rinsing the semicircular filter and cup under running water. To remove the filter device, pull the cup handle in the upward direction.

### WARNING.

- The dishwasher must never be used without the filters.
- Improper replacement of the filter may reduce the performance level of the appliance and damage dishes and utensils.

1

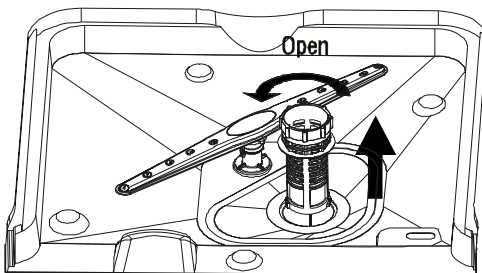

Step 1  
Turn the filter in an anti-clockwise direction and then lift up.

2

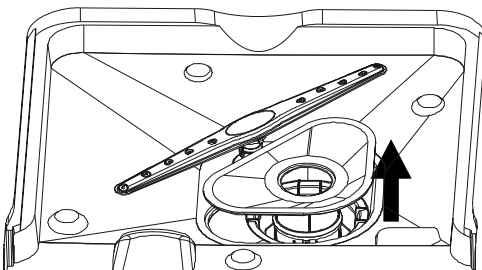

Step 2  
Lift the main filter up.

3

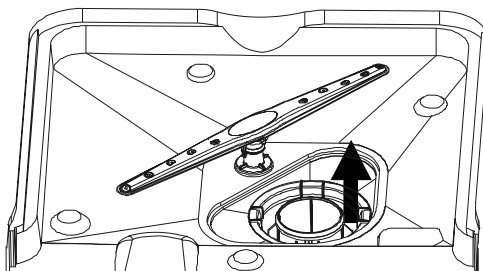

Step 3  
Lift the fine filter up.

**IMPORTANT.** When following this procedure from step1 to step 3, the filter system will be removed; when following it from Step 3 to Step 1, the filter system will be installed.

# Care and Maintenance

Inspect the filters for blocking every time after the dishwasher has been used.

By unscrewing the coarse filter, you can remove the filter system. Remove any food remnants and clean the filters under running water.

The entire filter assembly should be cleaned once a week.

## Cleaning the Filter

To clean the coarse filter and the fine filter, use a cleaning brush. Reassemble the filter parts as shown in the figures on the previous page and reinsert the entire assembly in the dishwasher, positioning it in its seat and pressing downwards.

**WARNING.** When cleaning the filters, don't knock on them. Otherwise, the filters could be contorted and the performance of the dishwasher could be decreased.

## Caring for the Appliance

The control panel can be cleaned by using a lightly dampened cloth. After cleaning, make sure to dry it thoroughly.

For the exterior, use a good appliance polish wax.

Never use sharp objects, scouring pads or harsh cleaners on any part of the dishwasher.

## Cleaning the Door

To clean the edge around the door, you should use only a soft warm, damp cloth. To avoid penetration of water into the door lock and electrical components, do not use a spray cleaner of any kind.

### WARNING.

- Never use a spray cleaner to clean the door panel as it may damage the door lock and electrical components.
- Abrasive agents or some paper towels should not be used because of the risk of scratching or leaving spots on the stainless steel surface.

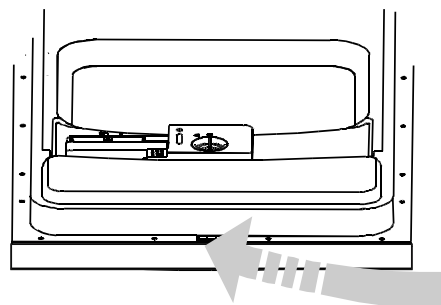

## Protect Against Freezing

Please take frost protection measures on the dishwasher in winter. Please operate as follows:

1. Cut off the electrical power to the dishwasher.
2. Turn off the water supply and disconnect the water inlet pipe from the water valve.
3. Drain the water from the inlet pipe and water valve. (Use a pan to catch the water)
4. Reconnect the water inlet pipe to the water valve.
5. Remove the filter at the bottom of the tub and use a sponge to soak up water in the sump

# Care and Maintenance

**IMPORTANT.** If your dishwasher cannot work because of the ice, please contact Viali customer care or a qualified technician.

## Cleaning the Spray Arms

- It is necessary to clean the spray arms regularly as hard water chemicals will clog the spray arm jets and bearings.
- To remove the spray arms, screw off the nut clockwise to take out the washer on top of the spray arm and remove the arm.
- Wash the arms in soapy and warm water and use a soft brush to clean the jets.
- Replace them after rinsing them thoroughly.

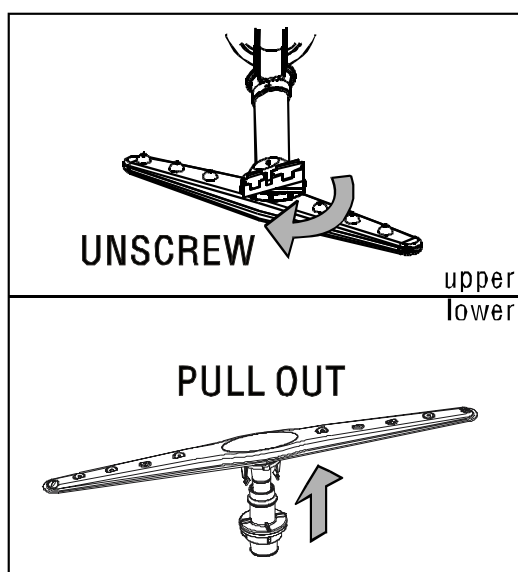

# Technical Specifications

Height: 850mm

Width: 600mm

Depth: 580mm

Voltage Connected Load: see rating label

Water Pressure: 50-600kPa

Power Supply: see rating label

Capacity: 12 Place Setting

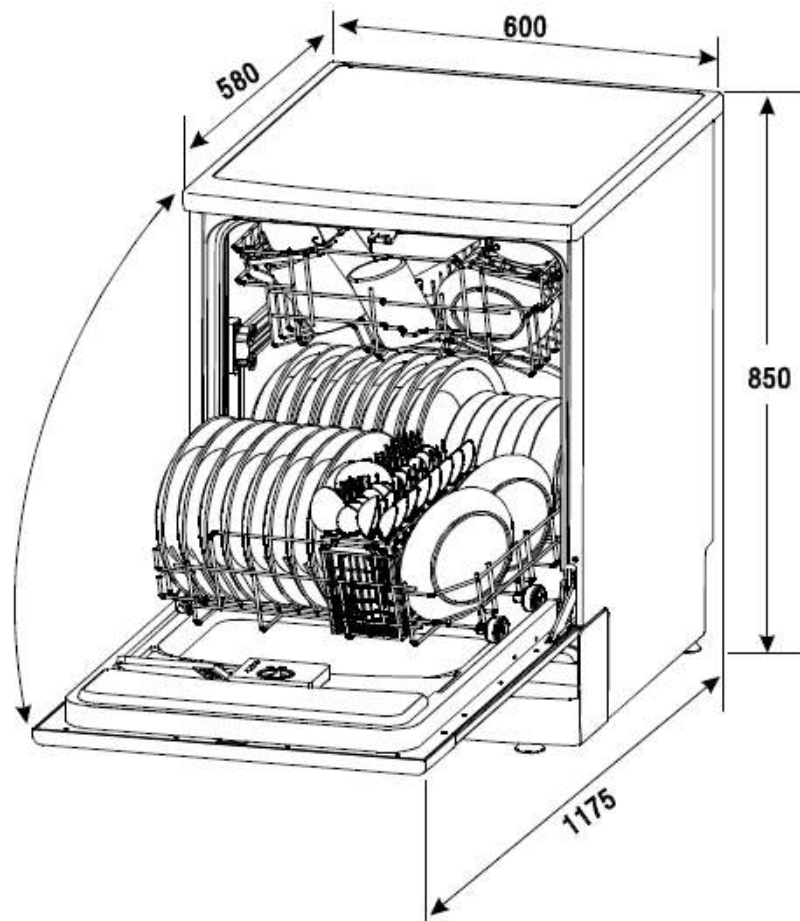







M.E.W. (Australia) Pty Ltd

15 Vaughan Street

Essendon Fields VIC 3041

ACN 152 719 036

1300 650 966

[customercare@vialiproducts.com.au](mailto:customercare@vialiproducts.com.au)

While every effort has been made in the preparation of this instruction manual, the publishers cannot be held responsible for the accuracy of the information contained herein or any consequences arising from it.